



Moba Robot Casepacker and Displayloader series

MR10-MR20-MR30

MR 10-20-30

The MR 10-20-30 are part of the “Moba Robotics” series. This range of robots is designed to be able to handle consumer packs and pack them into cases, crates, display pallets or shippers.

The MR 10 is specifically designed to pack consumer packs into cases or crates and can be connected directly behind a block of packinglanes. The MR 20 packs consumer packs or trays in- or onto displays or shippers. It can be connected behind the grader in a limited number of configurations, but will mostly be connected through a conveyor system away from the grader.

The MR 30 robot finally, combines the capabilities of MR 10 and MR 20 into a very flexible solution for further automation of your packing station. This robot can be set up either as casepacker or as a displayloader. Since the dimensions of the MR 30 are similar to the MR 20, it can only be connected behind the grader in a limited number of configurations and will therefore mostly be positioned away from the grader as well.

Basic capacity of the robot is approximately 38,000 eggs per hour (106 cases per hour), based on 48 eggs per stroke (case packing) and 60 eggs per stroke for display loading, including layer pads every 3 layers.



Capacity of the robot depends on the number of packs that can be picked up at the same time and the pattern that has to be formed.

Configurations can be tailor made with following functions:

MR 10

Standard:

- Robot cell with gripper head
- Double pick up position
- 1 case packing line with
 - 3 empty case positions
 - 1 case loading position
 - 1 full case buffering position
 - Transfer onto case conveyor

- Safety fence

Optional:

- Extended gravity conveyor for manual input of empty cases
- Case alignment unit
- Inline supply including open box reject conveyor
- Single pick-up point to connect to Contiflow
- Pack rotation unit, to be able to create ready-to-pick-up patterns
- Packsplitter, double or single
- Case or crate stacker, to stack low cases
- 3rd party case erector

MR20

Standard:

- Robot cell with gripper head
- Double pick up position
- Straight display loading and transport line with
 - 2 empty pallet positions
 - 1 display loading position
 - 3 full display positions
- Layer pad storage
- Safety fence

Optional:

- U-shaped pallet transport, 3 empty, 1 loading, 5 full pallet positions
- Inline supply including open box reject conveyor
- Single pick-up point to connect to Contiflow
- Pack rotation unit, to be able to create ready-to-pick-up patterns
- Packsplitter, double or single
- Pallet transport extension; per 2 pallet positions

MR30

Standard:

- Robot cell with gripper head
- Double pick up position
- 1 case packing line with
 - 3 empty case positions
 - 1 case loading position
 - 1 full case buffering position
 - Transfer onto case conveyor
- Straight display loading and transport line with
 - 2 empty pallet positions
 - 1 display loading position
 - 4 full display positions
- Layer pad storage
- Safety fence

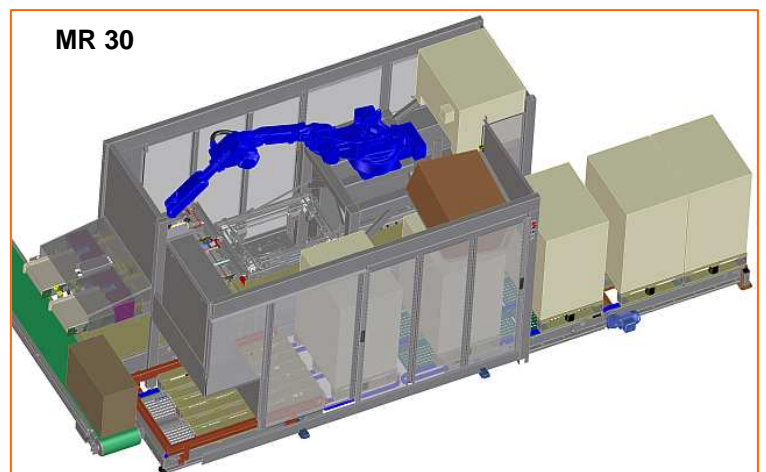
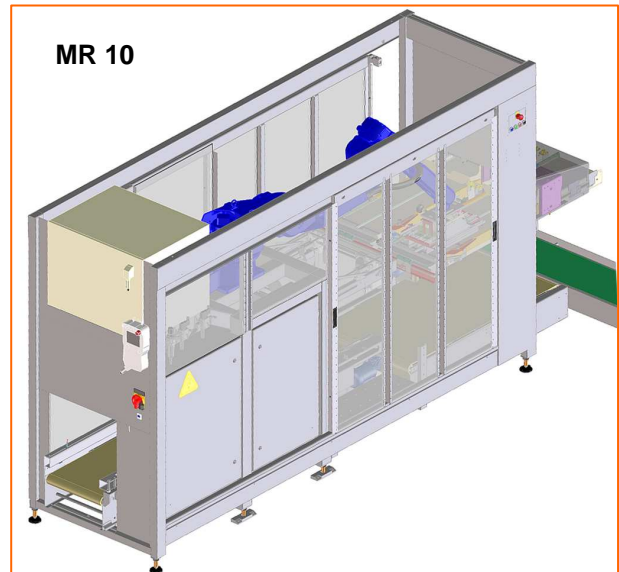

Optional:

- U-shaped pallet transport, 3 empty, 1 loading, 5 full pallet positions
- Inline supply including open box reject conveyor.
- Single pick-up point to connect to Contiflow
- Pack rotation unit, to be able to create ready-to-pick-up patterns
- Packsplitter, double or single
- Case or crate stacker, to stack low cases
- 3rd party case erector
- Pallet transport extension; per 2 pallet positions

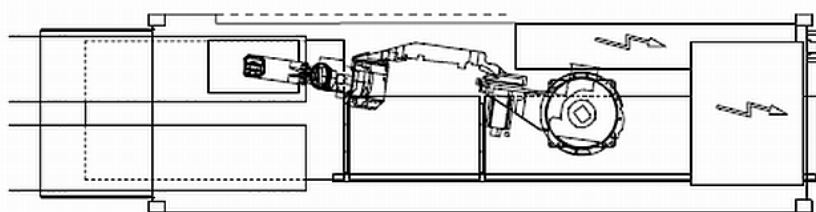

Standard layouts:

MR10	
MR 20	<p>Technical drawing of the MR 20 standard layout. It shows a robotic arm and conveyor system similar to the one above, but with a different configuration of components. A lightning bolt symbol is visible on the left side of the conveyor. Below the main drawing, there is a detailed view of the conveyor structure with an arrow pointing to the right.</p>
MR 30	<p>Technical drawing of the MR 30 standard layout. It shows a robotic arm and conveyor system similar to the one above, but with a different configuration of components. A lightning bolt symbol is visible on the left side of the conveyor. Below the main drawing, there is a detailed view of the conveyor structure with an arrow pointing to the right.</p>

DISCLAIMER:

MOBA

Moba continuously improves its products. Images and data in this brochure can therefore differ from the latest configuration.